

40 Amp Electrical Switch Assembly Enclosed - (514-0103)

Wiring Instructions

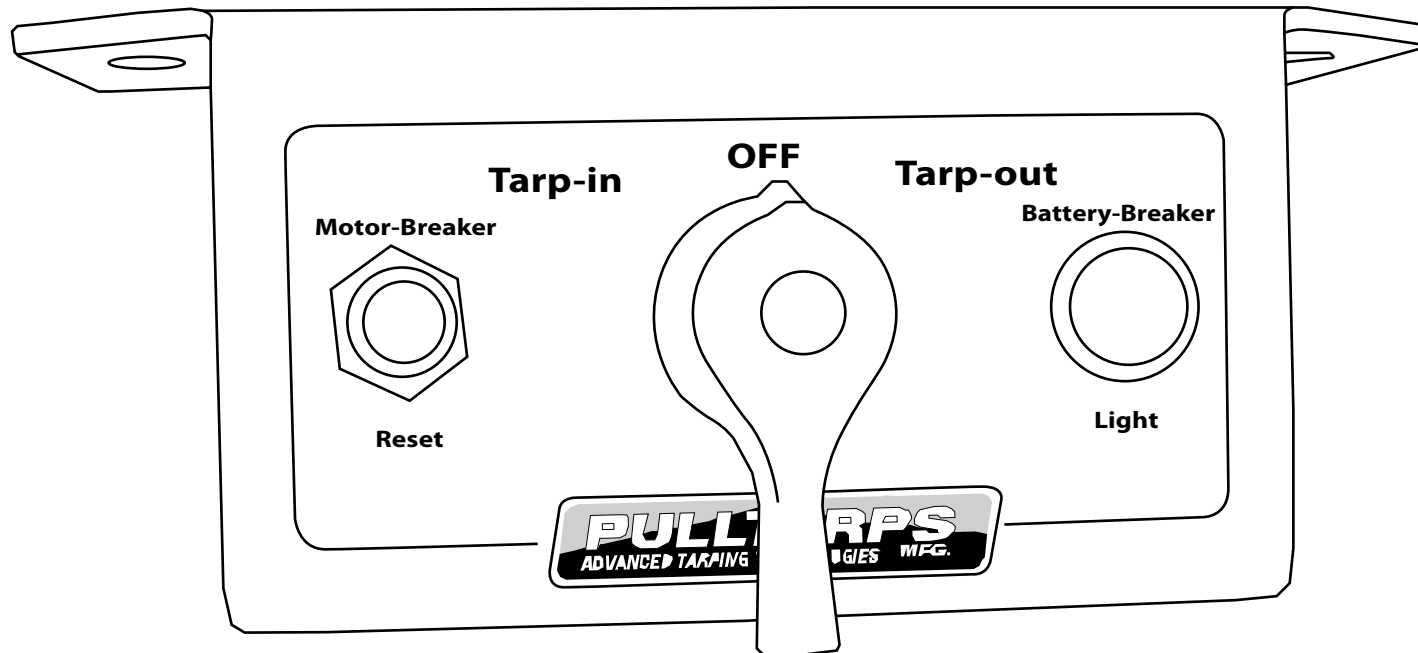

1404 N. Marshall Ave, El Cajon, CA 92020
For Technical Assistance
Call Toll Free: (800) 368-3075

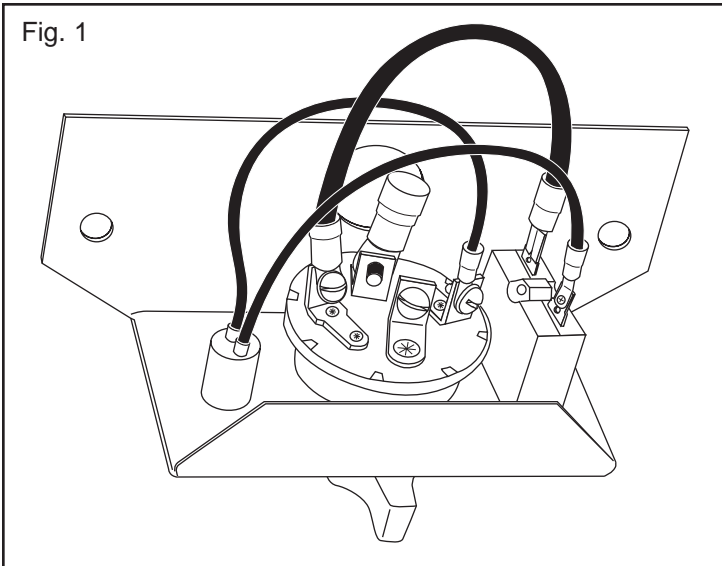

The switch panel (514-0103) comes assembled as shown in Fig. 1.

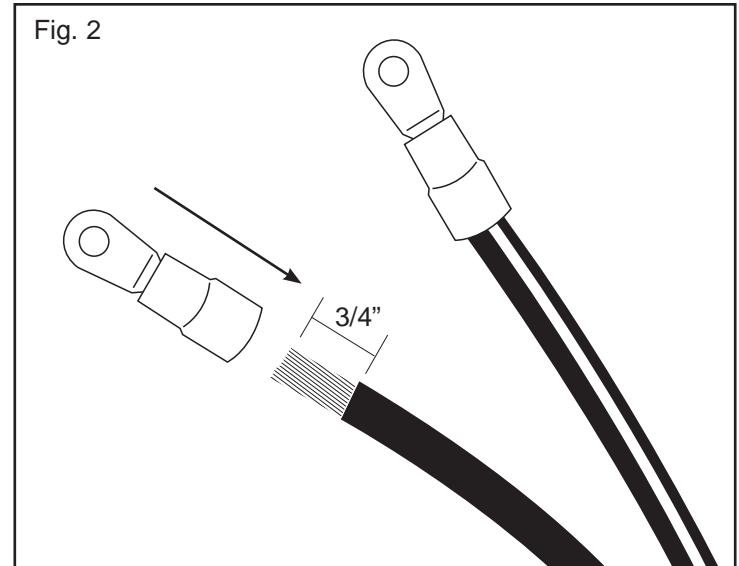

Step 2. Attaching The Connectors

Strip the ends of the 6 ga. wire approximately 3/4" and attach the light blue connectors (see Fig. 2) using a pair of wire crimpers. The dark blue connectors will be used on the battery.

Step 3. Wiring The Motor

Run the 6 ga. black wire from the #2 terminal on the motor to the 40 amp "Push To Reset" breaker on the switch panel as shown in Fig. 3.

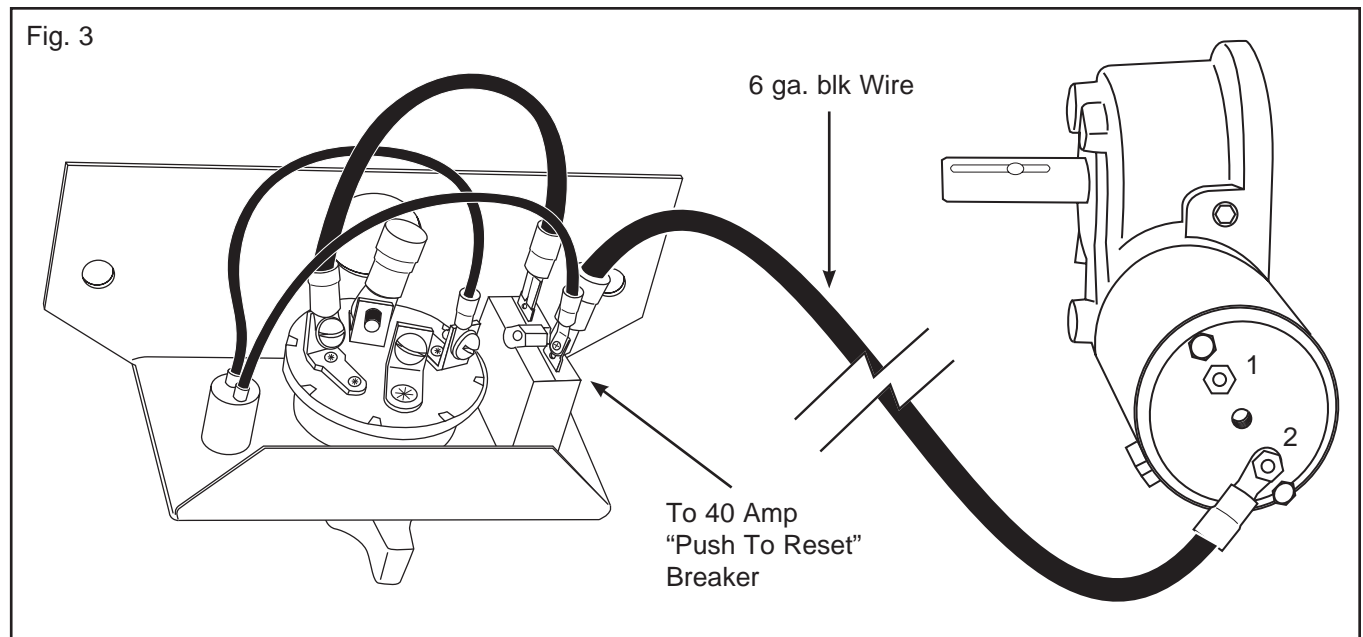

Step 4. Wiring The Motor

Run the 6 ga. black / red wire from the #1 terminal on the motor to A2 as shown in Fig. 4.
(A2 is also labeled on the switch panel)

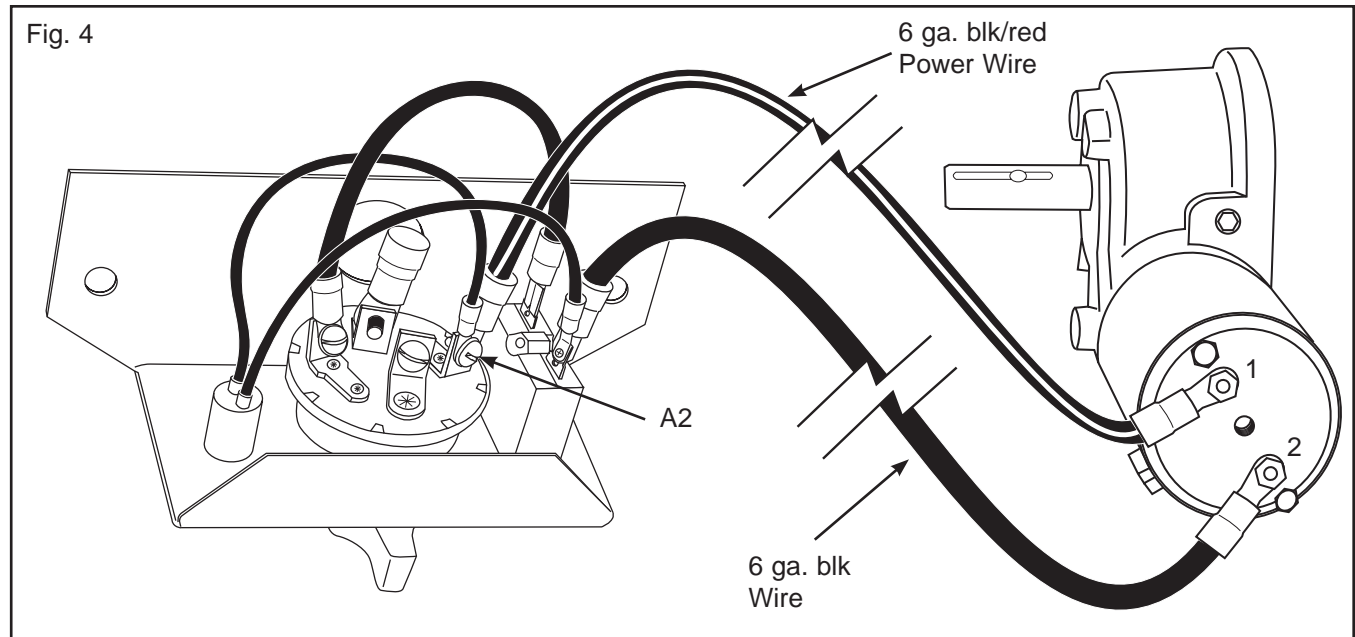

Step 5. Running The Ground Wire To The Battery

Run the 6 ga. black wire from B2 on the switch to the negative terminal on the battery as shown in Fig. 5.
(B2 is also labeled on the switch panel)

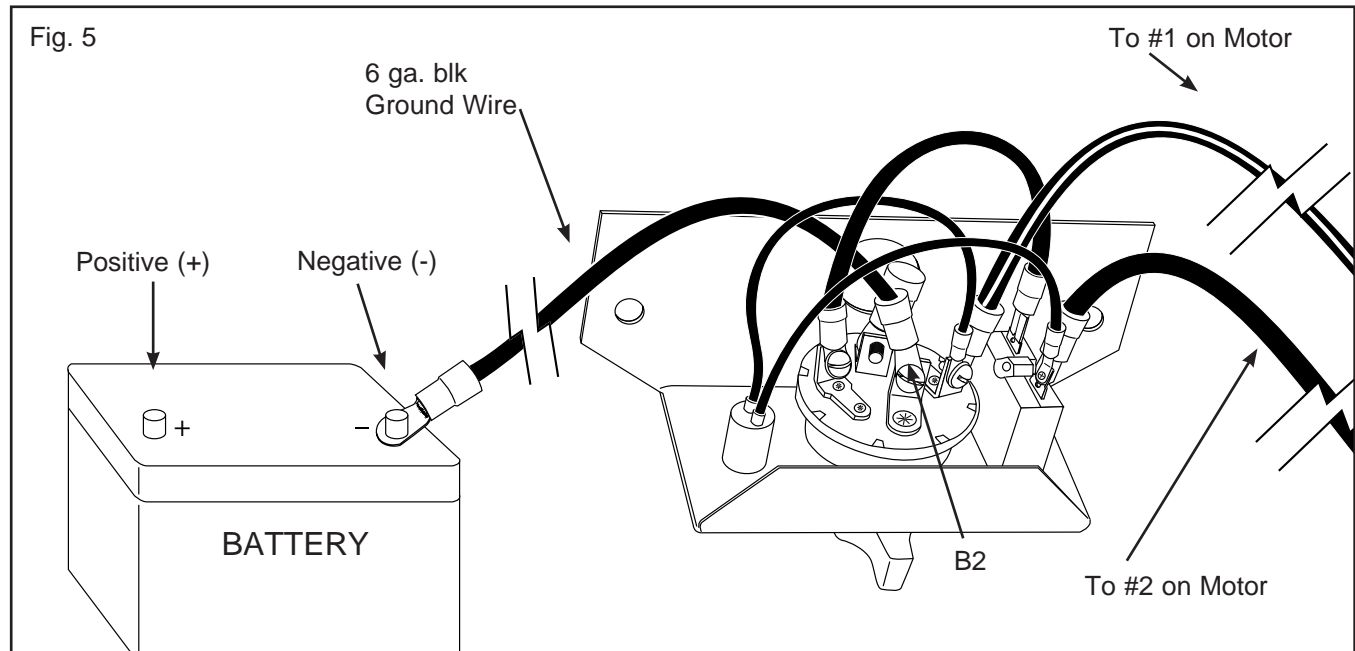

Step 6. Wiring The 40 Amp “Non Cycle” Breaker

Run the 6 ga. black / red wire from B1 on the switch panel to the AUX terminal on the 40 amp “Non Cycle” breaker as shown in Fig. 6.

NOTE: The large hole on top of the switch is for easy access to the B1 screw.

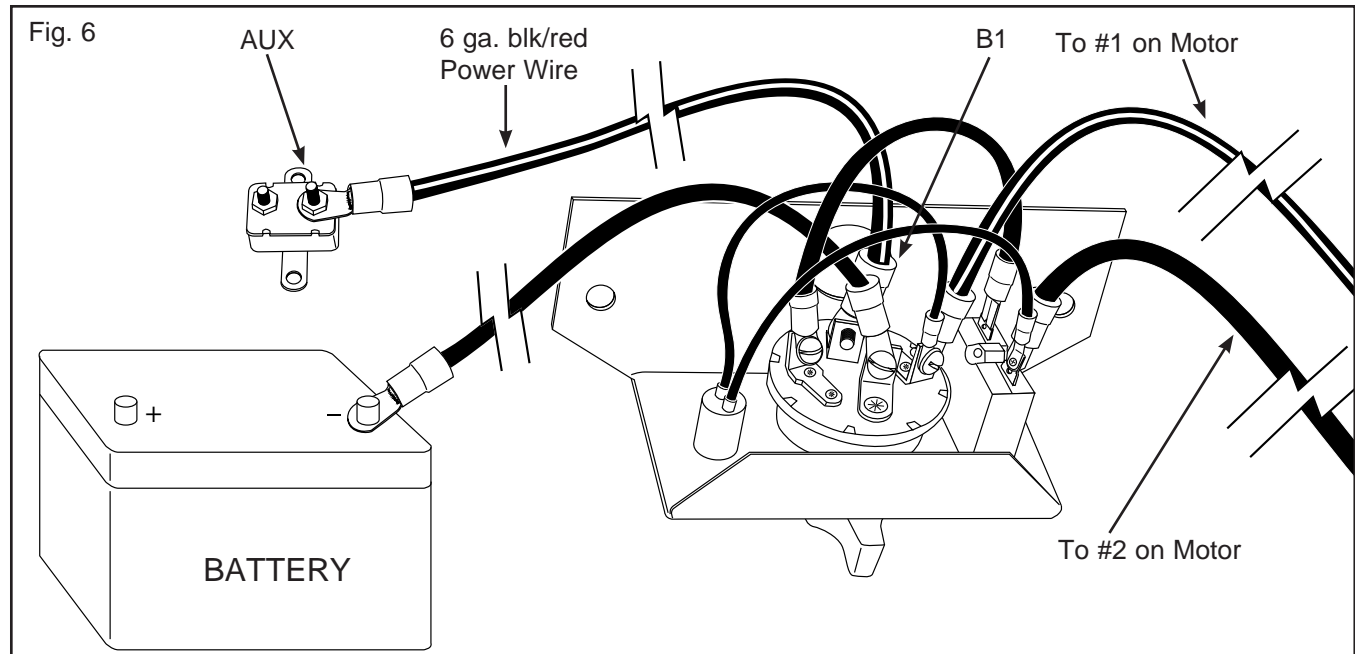

Step 7. Wiring The 40 Amp “Non Cycle” Breaker

Run the 6 ga. black / red wire from BAT on the 40 amp “Non Cycle” Breaker to the positive terminal on the battery as shown in Fig. 7.

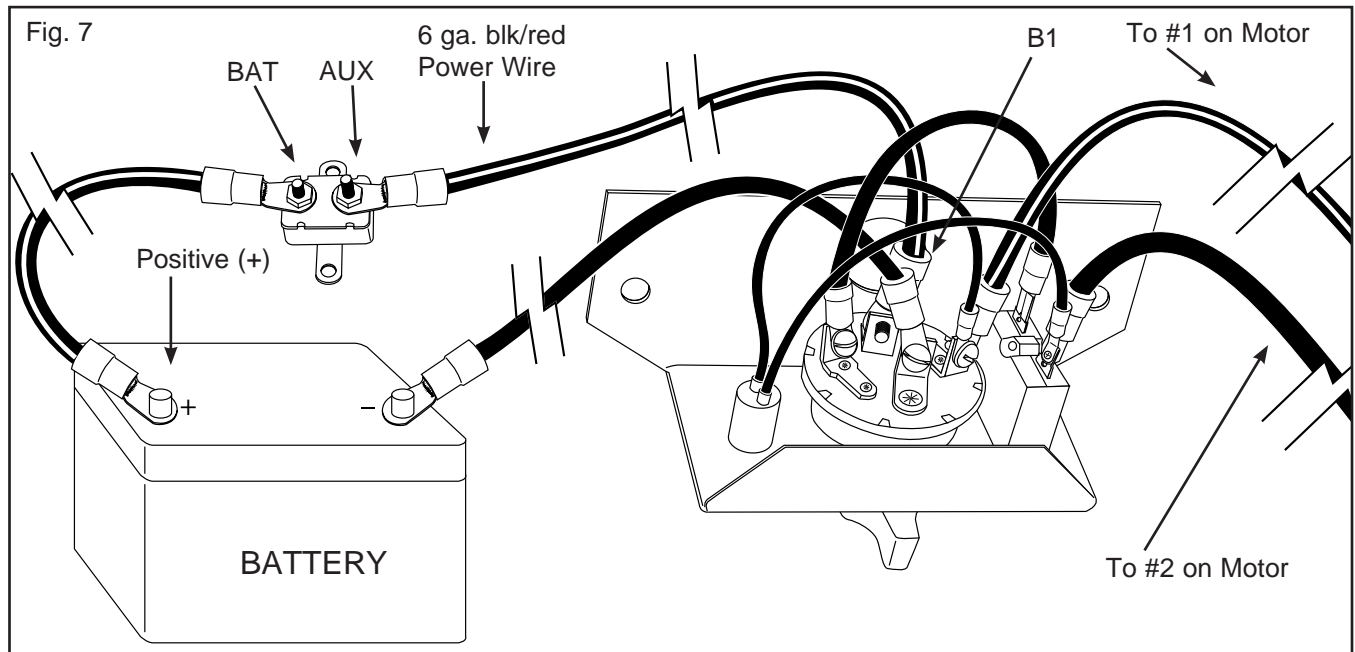

Option #1. Plug Assembly - Part # 514-0505

Assemble the Quick Disconnect as shown in Fig. 8 and Fig. 9.

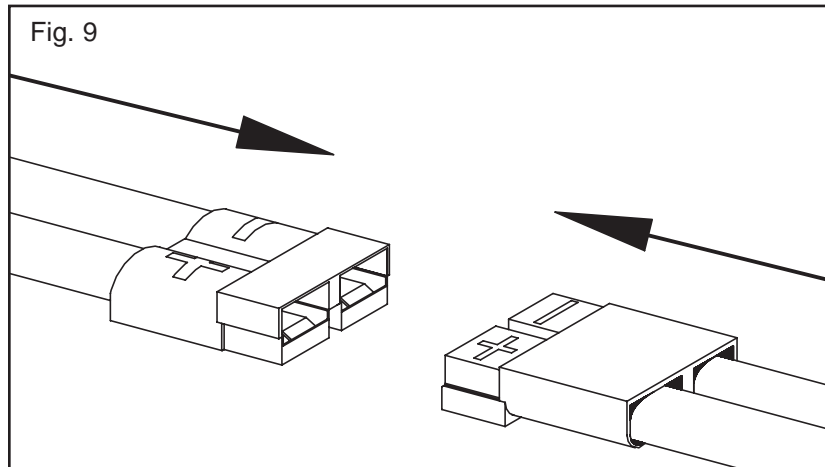
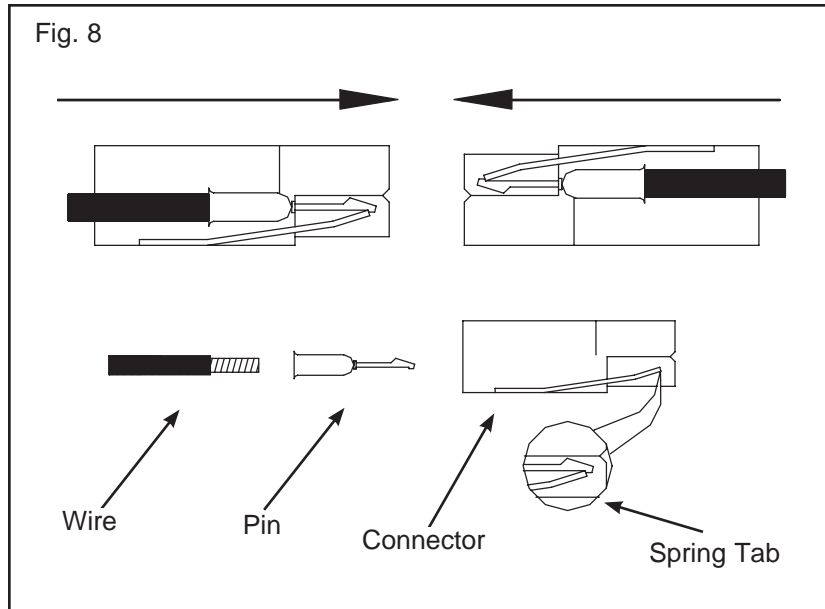

Option #2. Plug Assembly - Part # 514-0501

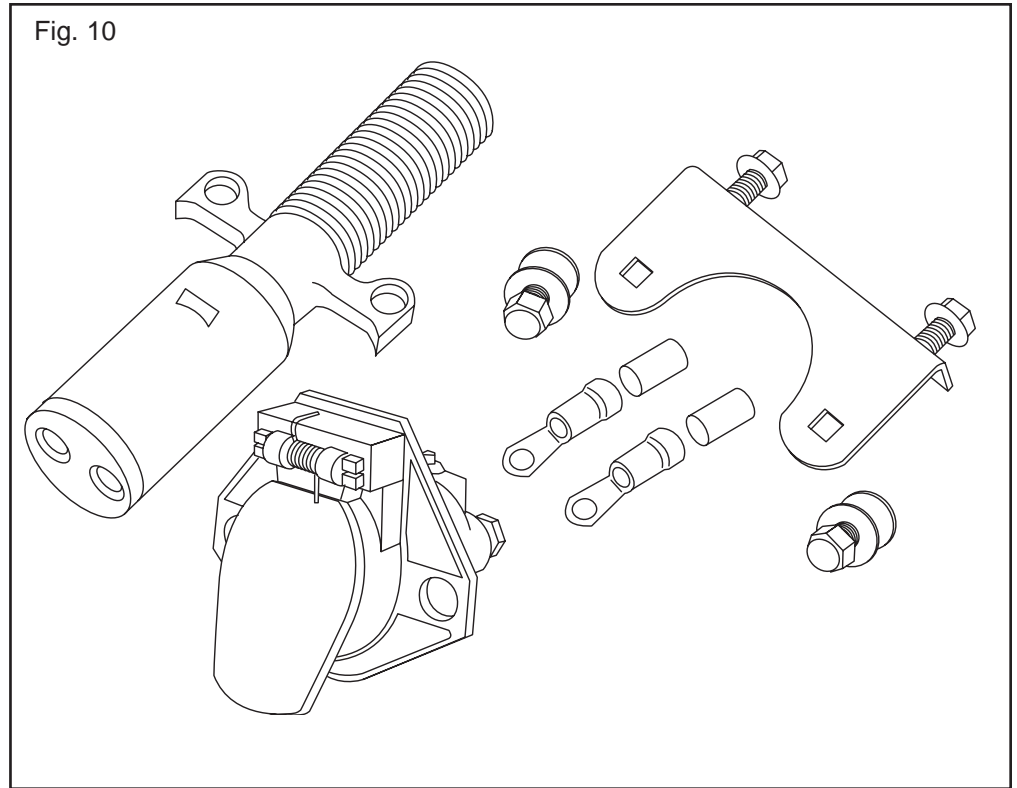

40 Amp Electrical Switch Assembly - (514-0103)

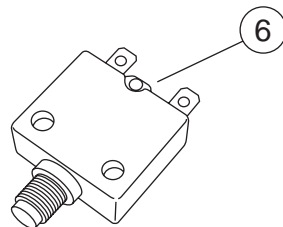
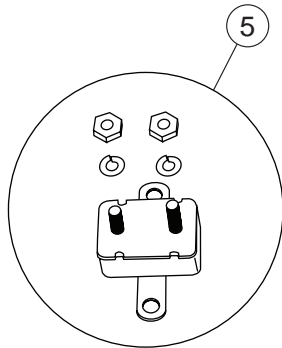
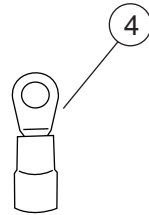
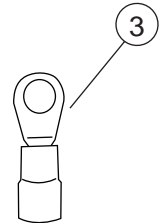
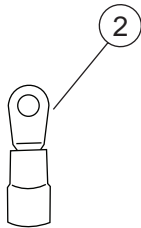
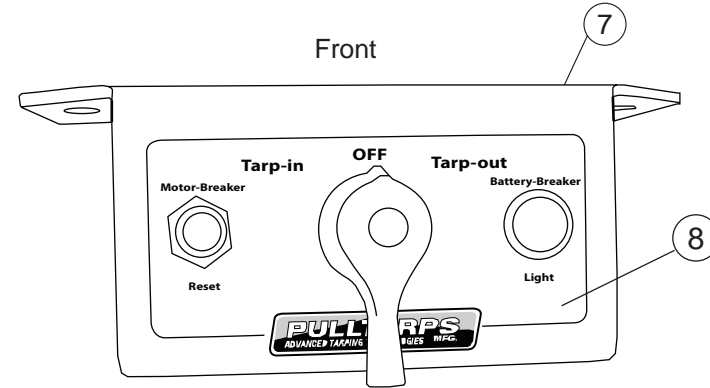
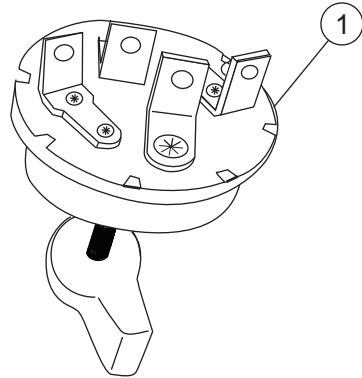

Item #	Part #	Description:	QTY:
1	514-0107	Electric Switch 3 Position	1
2	514-0307	Connector 6 ga. #10 Stud	6
3	514-0308	Connector 6 ga. Lug with 3/8" Eyelet	2
4	514-0309	Connector 6 ga. Lug with 1/4" Eyelet	2
5	514-0405	40 Amp Type II Breaker	1
6	514-0406	40 Amp "Push to Reset Breaker"	1
7	514-9909	Switch Bracket for Arm System	1
8	517-0213	12V Label Electric Switch	1



1404 N. Marshall Ave, El Cajon, CA 92020
 For Technical Assistance
 Call Toll Free: (800) 368-3075